

Compressed Air & High Pressure Gas Connections



Blockwise Engineering LLC
www.blockwise.com

Many Blockwise machines require compressed air or high-pressure gas connections.

Most medical device factories have **“normal” compressed air** distributed through the manufacturing area, regulated in the range of 6.9 to 8.3 bar (100 to 120 psi), for example. On Blockwise machines, it is used in air cylinders, cooling nozzles, vacuum venturis, etc.

Connect the normal compressed air by inserting a ¼-inch OD plastic tube into the “instant tube fitting” (also called “push-to-connect tube fitting” or “one-touch tube fitting”). Use a pressure regulator. Set the pressure in the range written on the machine’s label:

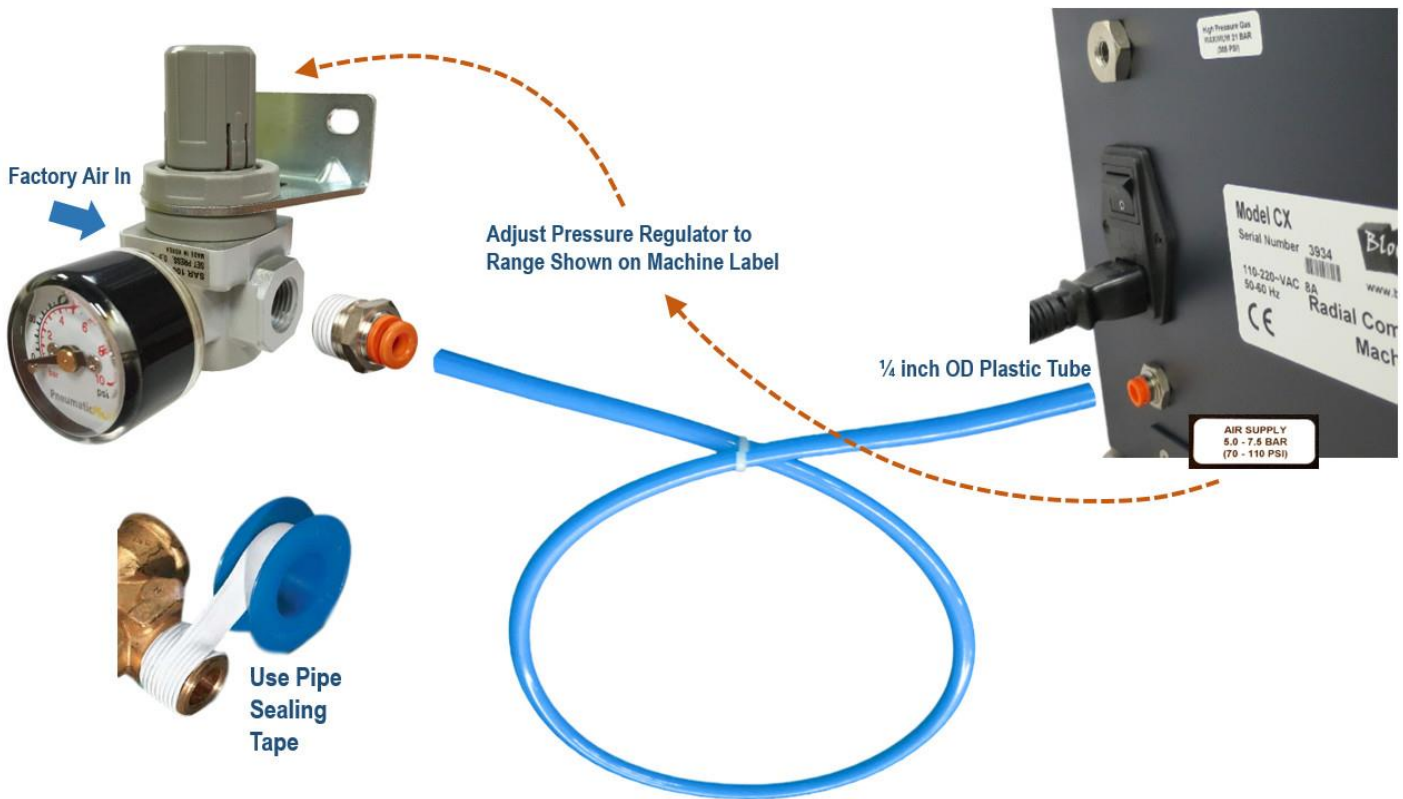

If necessary, use an adapter:



Compressed Air & High Pressure Gas Connections



Blockwise Engineering LLC
www.blockwise.com

Some Blockwise machines (such as model CX crimper) also require **high-pressure gas**, usually regulated to 21 bar (305 psi) to pressurize a product such as a balloon, as part of the manufacturing process. Typically, this is supplied from a high-pressure bottle of nitrogen with a pressure regulator. The machine works properly with air or nitrogen; the customer should choose air or nitrogen depending on the convenience and cleanliness of the source and compatibility with their product.

Use a braid-reinforced hose or tubing rated for 350 psi or more. Connect to the NPT 1/8 pipe fitting on the machine. Set the pressure regulator to 21 bar (305 psi). Use pipe adapters if needed.

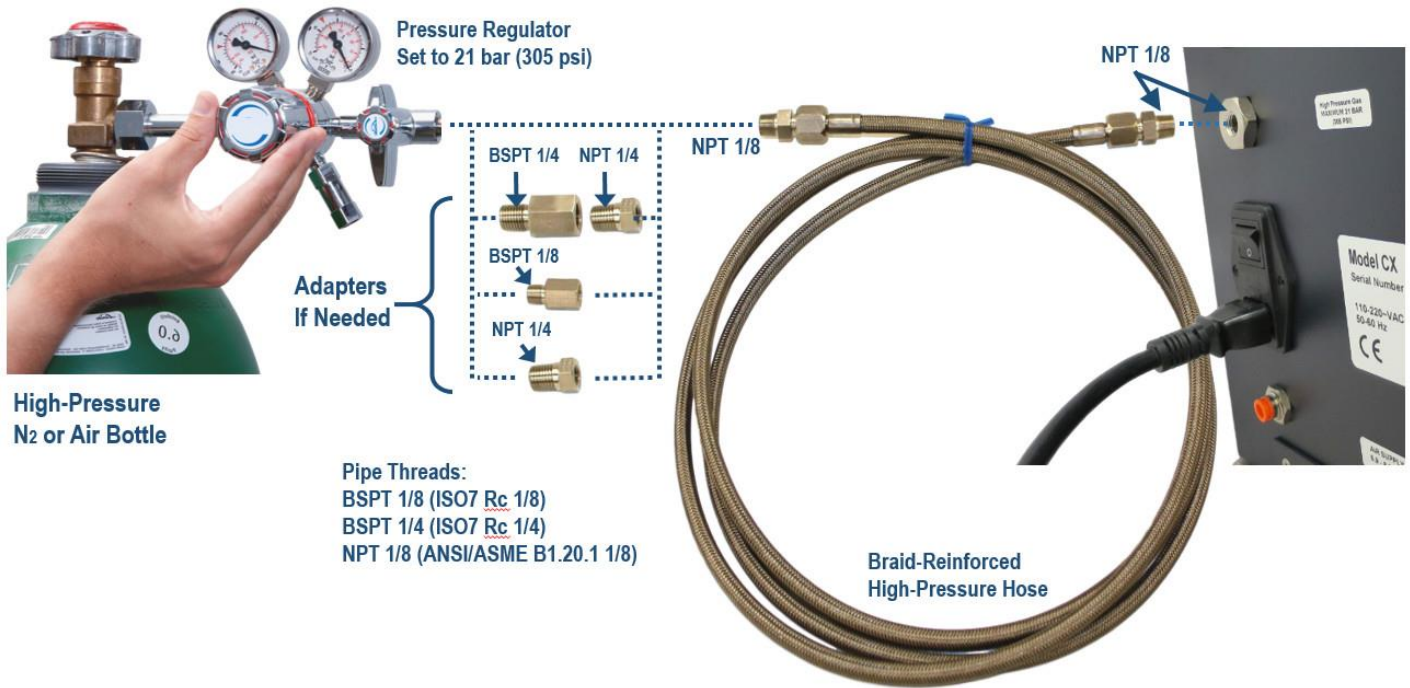

Use PTFE pipe tape.

